



PRODUCT SHEAR VALVES

EBW® product shear valves immediately stop product flow in the event of fire or collision at the dispenser. A patented adapter shears upon impact, causing the poppet to seal on the valve body, preventing fuel spillage. If fire occurs, a fusible link releases the fulcrum arm, engaging the poppet.

HIGHLIGHTS

- Standard 1½" openings allow minimal flow restriction and a pre-drilled test plug is included for line pressure testing
- Can be boss or U-bolt mounted.
- E-coated for corrosion protection and AGB compatibility.
- Easy-to-replace adapters slide on and off valve base without lifting the dispenser.
- Adapters are available in male, female or, union connections.
- Single poppet models stop product flow from the pump. Double poppet models stop flow from the pump and dispenser piping.

ORDERING INFORMATION

Shear Valves

| Model | Description |
|------------|---|
| 662500901 | Single poppet shear valve, union, 1½" NPT |
| 662500902 | Single poppet shear valve, female, 1½" NPT |
| 662500903 | Single poppet shear valve, male, 1½" NPT |
| 662510902 | Single poppet shear valve, female, 1½" BSPT |
| 662510903 | Single poppet shear valve, male, 1½" BSPT |
| 662501901 | Double poppet shear valve, union, 1½" NPT |
| 662501902 | Double poppet shear valve, female, 1½" NPT |
| 662501903 | Double poppet shear valve, male, 1½" NPT |
| 662511902 | Double poppet shear valve, female, 1½" BSPT |
| 662511903 | Double poppet shear valve, male, 1½" BSPT |
| 662502902* | Double poppet shear valve, normally closed, female, 1½" NPT |

*UL listed only.

U-Bolt Kit

Holds the single or double poppet shut-off valve rigidly in place, ensuring proper shearing.

| Model | Description |
|----------|-------------------------------|
| 66213801 | U-bolt kit, 0.3 lbs (0.14 kg) |

SPECIFICATIONS

- Fusible link closes poppet at 165.0 °F (73.9 °C).
- Top and body material: E-coated cast iron
- Poppet and O-ring: Fluorocarbon
- Stem and poppet spring: Stainless steel

Approvals/Certifications

- Meets NFPA 30A requirements.
- UL and ULC listed. UL 842A and 842B approved for E-85 alcohol/gas blends and Biodiesel.
- ATEX approved, SIRA 13ATEX9035U.

Dimensions

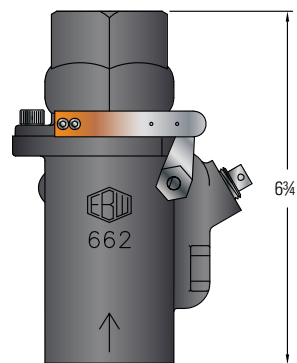
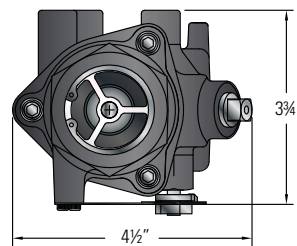

Female Double Poppet

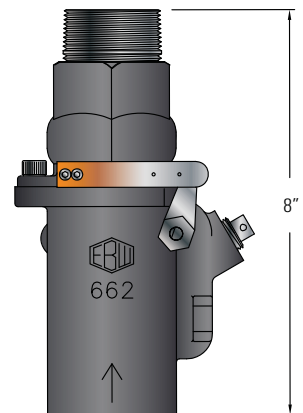

Male Double Poppet

PRODUCT SHEAR VALVE ACCESSORIES AND REPLACEMENT TOPS

Shear Valve Replacement Parts

| Model | Description |
|-------|-----------------|
| 90074 | Fulcrum arm kit |

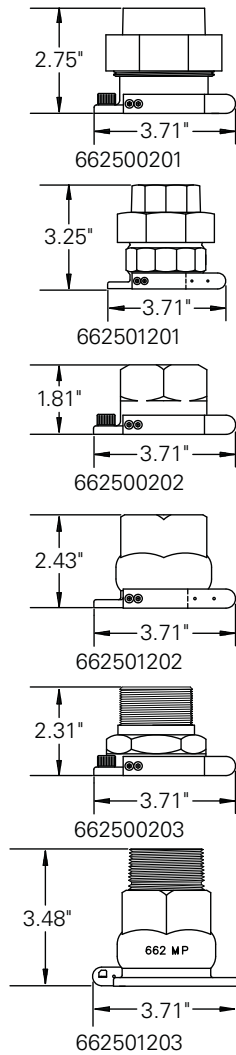

1½" Union Adapter Replacement Tops

| Model | Description | Poppet | Shear Valve Adapter | Thread |
|-----------|----------------------------|--------|---------------------|--------|
| 662500201 | Shear valve top union 1.5" | Single | 662500901 | Union |
| 662501201 | Shear valve top union 1.5" | Double | 662501901 | Union |

1½" Female Adapter Replacement Tops

| Model | Description | Poppet | Shear Valve Adapter | Thread |
|-----------|-------------------------------------|--------|---------------------|--------|
| 662500202 | Shear valve top female 1.5" NPT | Single | 662500902 | NPT |
| 662501202 | Shear valve top female 1.5" NPT | Double | 662501902 | NPT |
| 662502202 | Shear valve top female N/C 1.5" NPT | Single | 662502902 | NPT |
| 662511202 | Shear valve top female 1.5" BSPT | Double | 662511902 | BSPT |
| 662510202 | Shear valve top female 1.5" BSPT | Single | 662510902 | BSPT |

1½" Male Adapter Replacement Tops

| Model | Description | Poppet | Shear Valve Adapter | Thread |
|-----------|----------------------------------|--------|---------------------|--------|
| 662500203 | Shear valve top male 1.5" NPT | Single | 662500903 | NPT |
| 662501203 | Shear valve top male 1.5" NPT | Double | 662501903 | NPT |
| 662510203 | Shear valve top male 1.5" BSPT | Single | 662510903 | BSPT |
| 662511203 | Shear valve top female 1.5" BSPT | Double | 662511903 | BSPT |

Note: Replacing tops negates the ATEX approval. Entire unit must be replaced to remain in compliance with ATEX approval.

